

Revision
Letter

Change
Description

A

Drawing Number changed to
match numbering standard, was
JSX-SFC01.

Drill through 1 collar half using 3/32" [2.38mm] drill bit
centering hole on part, Install onto JSX-C03-02. Transfer
hole into JSX-C03-02. Install 3/32" x 7/16" Stainless Steel
Roll Pin. Tap Roll Pin flush with Collar face.

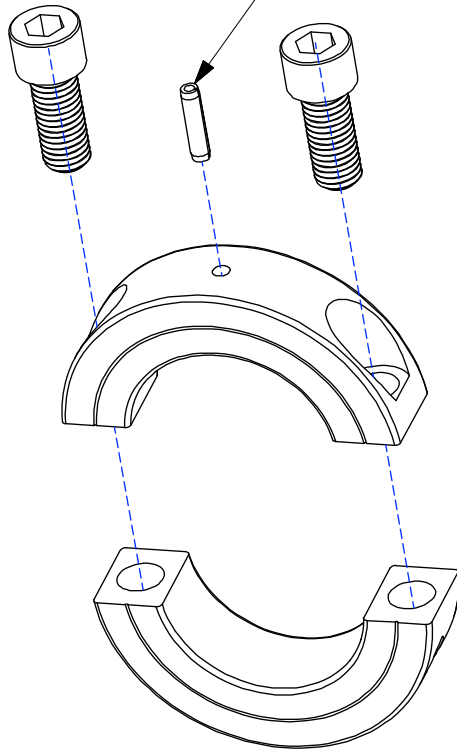

Detail of Collars
Scale: Full

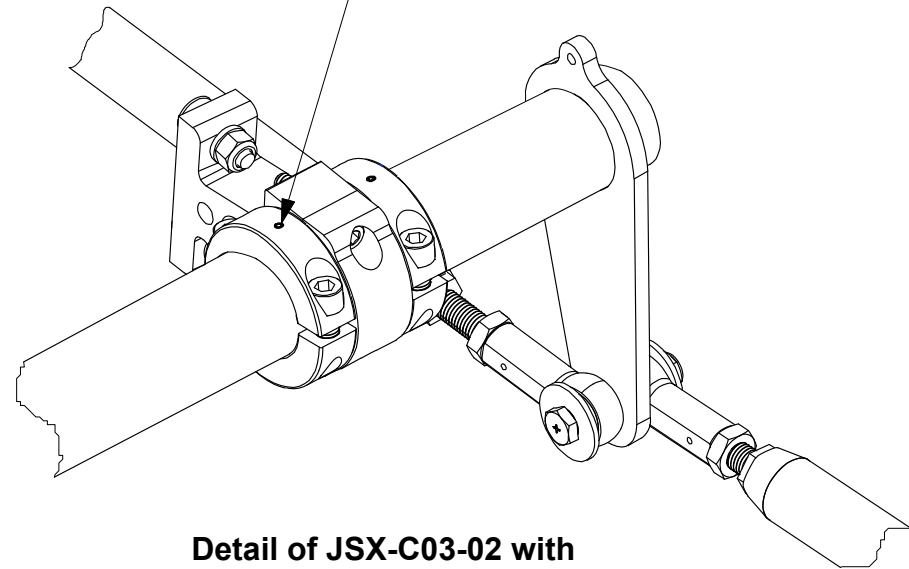

Detail of JSX-C03-02 with
Collars installed
Scale: 1/2

NOTE:
This detail was incorporated in the plans
beginning with JSX-C01 Rev E.

JSX-C03-48	1	Control System Rigging	JSX-C01
Dash / Part Number	Qty Req'd	Part Title	Next Assembly
<i>Sub</i> Sonex Control System Collars			
Drawing Scale	Drawing Number		Revision
Noted	JSX-C01-Detail I		A

Drill through 1 collar half using 3/32" [2.38mm] drill bit centering hole on part, Install onto JSX-C03-02. Transfer hole into JSX-C03-02. Install 3/32" x 7/16" Stainless Steel Roll Pin. Tap Roll Pin flush with Collar face.

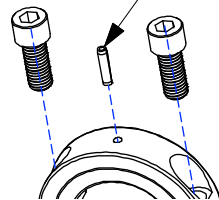

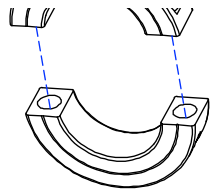

Detail I
2 Places
Scale 1:2